

Adjusting Procedure

Date : August 19, 2020
Document : 7-850389-B
Subject : Adjusting Setting Keyence glass fiber sensor
Author : August Tromp

Machine type:
ZEVAv 6848
ZEVA m 6846

Abstract:

This procedure described the setting of FS-N41C FIBER OPTIC SENSAMPLIFIER IO-LINK M8 NPN item 7-47647, that will be used in combination with FU-83C FIBER UNIT REFLECHEAT RESISTANT 300C 1M Item 7-47648 on the Conveyor system option in the ZEVA v and ZEVA m machines

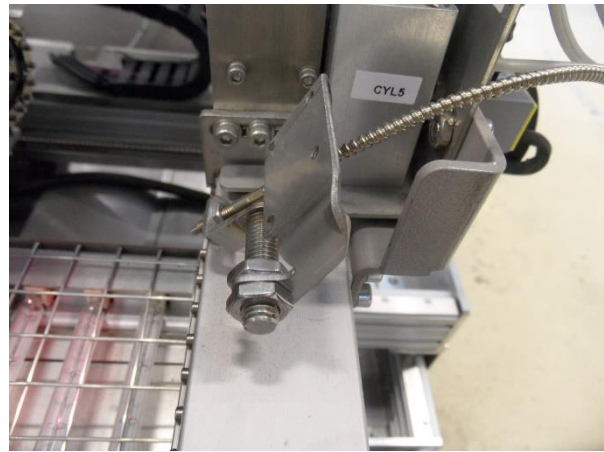

Figure 1: Item 7-47647 Keyence Amplifier Optic fiber and 7-47648 Fiber sensor on ZEVA m

Settings:

Note: Layout setting and mode

1. Bring the sensor to factory default settings

Initialization of Settings (Reset to Initial Values)

The sensor amplifier can be reset to the factory default settings.

- 1** Press and hold the [SET] and [PRE-SET] buttons simultaneously for 3 seconds or more.

The "rSt" display flashes.



- 2** Press the [MODE] button.

- 3** Press the  button to display "in it".



- 4** Press the [MODE] button.

After the settings are initialized, the screen displays "oL", which is then replaced with the current received light intensity.



Figure 2: Initialization of settings mode

2. Calibrate the sensor without PCB in the conveyor and calibrate the sensor with PCB in the conveyor
Use the PCB with the worst expected reflection as default.
Shown in the picture is the reflector type of sensor, we use the reflective type. The procedure is the same

Two-point Calibration

Two-point calibration is the most basic method of sensitivity setting.

The setting value can be established by simply pressing the [SET] button once each when a workpiece is present, and when it is absent.

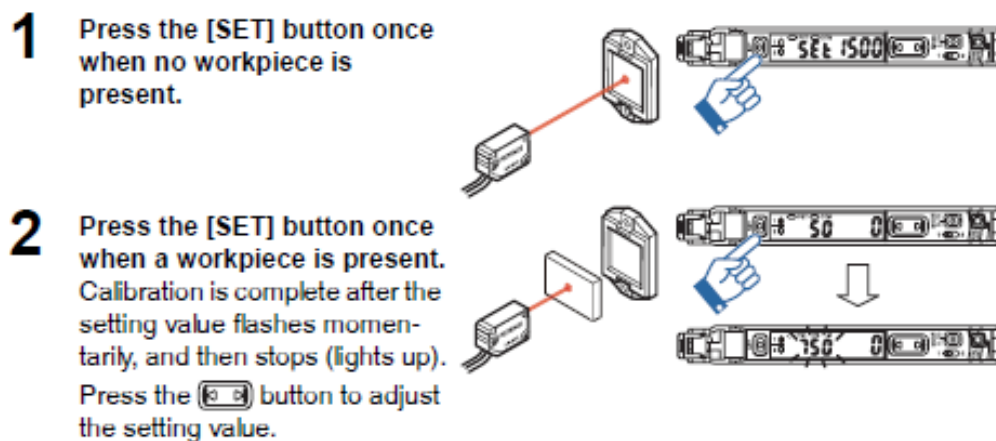
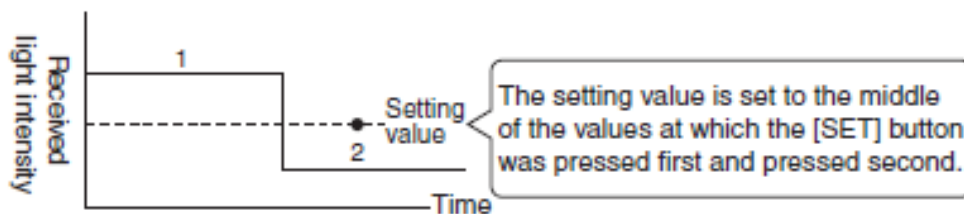

Figure 3: Two - Point calibration mode



- * If the difference between the 2 conditions is too small, "-" flashes after calibration is complete. However, the setting value will still be established.

Figure 4; Light intensity

Important: More information, please contact local service agent or ITW EAE helpdesk

- E-mail help desk NL > helpdesk.nl@itweae.com
- E-mail help desk USA > ysustsc@itweae.com
- E-mail help desk Asia > aphelpdesk@itweae.com